

Soils Map

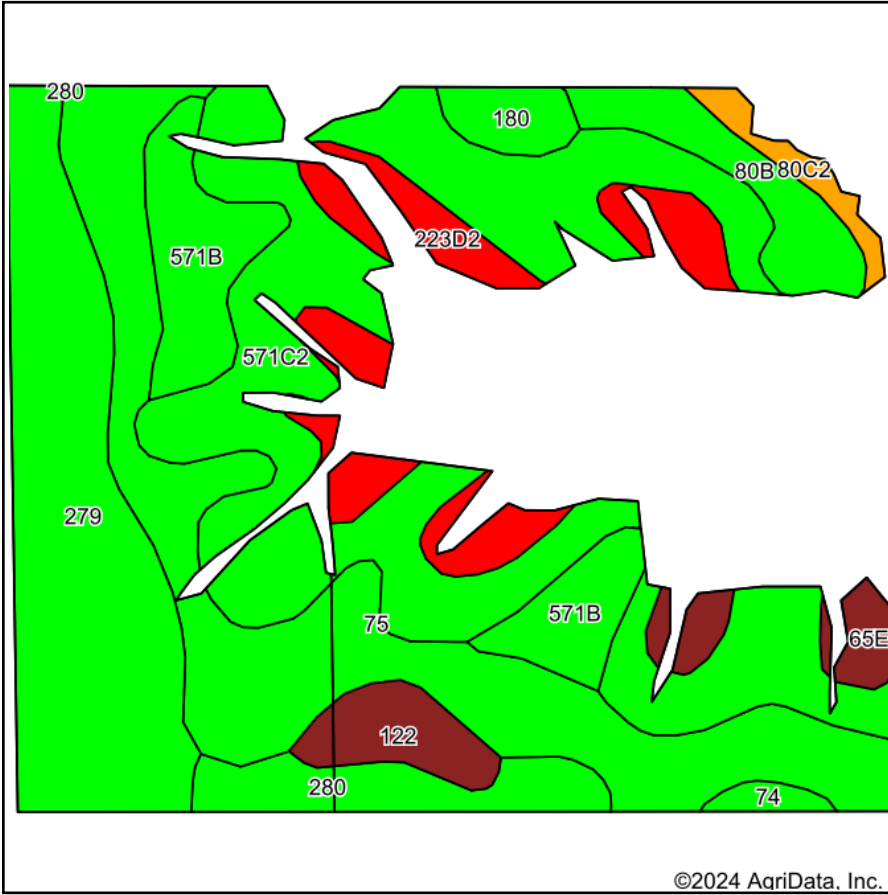

Soils data provided by USDA and NRCS.

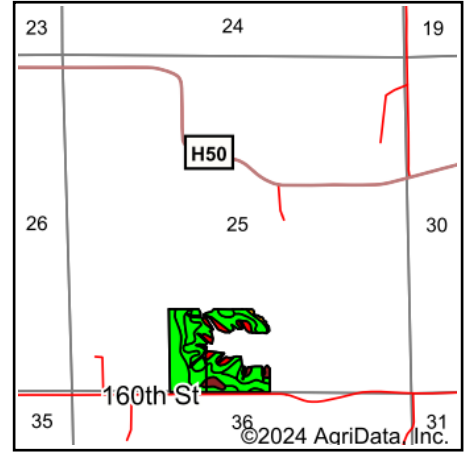

State: **Iowa**
 County: **Des Moines**
 Location: **25-71N-3W**
 Township: **Franklin**
 Acres: **34.82**
 Date: **3/1/2024**



Maps Provided By:



Area Symbol: IA057, Soil Area Version: 28

Code	Soil Description	Acres	Percent of field	CSR2 Legend	Non-Irr Class *c	CSR2**	CSR	
571C2	Hedrick silt loam, 5 to 9 percent slopes, moderately eroded	10.12	29.1%		IIIe	75	62	
75	Givin silt loam, 1 to 3 percent slopes	7.42	21.3%		Iw	80	75	
279	Taintor silty clay loam, 0 to 2 percent slopes	6.36	18.3%		IIw	83	88	
571B	Hedrick silt loam, 2 to 5 percent slopes	2.62	7.5%		Ile	85	82	
223D2	Rinda silt loam, 9 to 14 percent slopes, moderately eroded	2.47	7.1%		IVe	19	6	
280	Mahaska silty clay loam, 0 to 2 percent slopes	1.45	4.2%		Iw	94	95	
80B	Clinton silt loam, 2 to 5 percent slopes	1.39	4.0%		Ile	80	80	
122	Sperry silt loam, depressional, 0 to 1 percent slopes	0.98	2.8%		IIIw	36	63	
65E	Lindley loam, 14 to 18 percent slopes	0.73	2.1%		VIe	31	30	
180	Keomah silt loam, 1 to 3 percent slopes	0.59	1.7%		Iw	76	76	
80C2	Clinton silt loam, 5 to 9 percent slopes, eroded	0.47	1.3%		IIIe	69	60	
74	Rubio silt loam, 0 to 2 percent slopes	0.22	0.6%		IIIw	76	78	
Weighted Average						2.29	73.2	68.8

**IA has updated the CSR values for each county to CSR2.

*c: Using Capabilities Class Dominant Condition Aggregation Method